

Powered by *Tenda*

IP-COM

World Wide Wireless



IP-COM

ProFi Cloud System



Prodotti



- **Enterprise Router**



- **Enterprise Switch**



- **WLAN**



- **CPE**



- **Accessori**



- **ProFi System**





ProFi System

- La piattaforma Cloud ProFi permette la **messa a punto e la gestione** delle soluzioni di connettività IP-COM, in modo semplice, rapido ed efficiente.
- Le apparecchiature di rete possono essere installate facilmente ovunque e possono essere **gestite da remoto e divise per progetto**, tenendo sotto controllo costantemente la rete.





ProFi System



- Configurazione guidata supportata sia con l'account **locale** che in **Cloud**



- Dispone di una dashboard dei dati di funzionamento **completa, intuitiva** ed in **continua evoluzione**, con visione della **topologia della rete** e della **mappa Wi-Fi**



- Un account ProFi permette ad **ogni installatore** di gestire **fino a 1000 progetti**

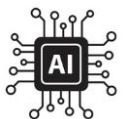

- Il sistema raccoglie le informazioni sull'ambiente wireless circostante, analizza in modo intelligente le informazioni e **regola automaticamente** il canale, la potenza e altre configurazioni in base ai risultati dell'analisi **AI**



- **Mobile App** per la gestione dei progetti da Android e iOS, completa di strumenti di **test della rete**

ProFi Cloud setup

1. **Registrazione** al link: <https://imsen.ip-com.com.cn/static/lrf/login>
2. Accesso a **codice Cloud univoco**
3. Impostazione del dispositivo per permettere la **gestione via Cloud**
4. Creazione **Progetto**
5. Aggiunta **dispositivi** al progetto

ProFi Cloud setup



- **Registrazione** al link: <https://imsen.ip-com.com.cn/static/lrf/login>

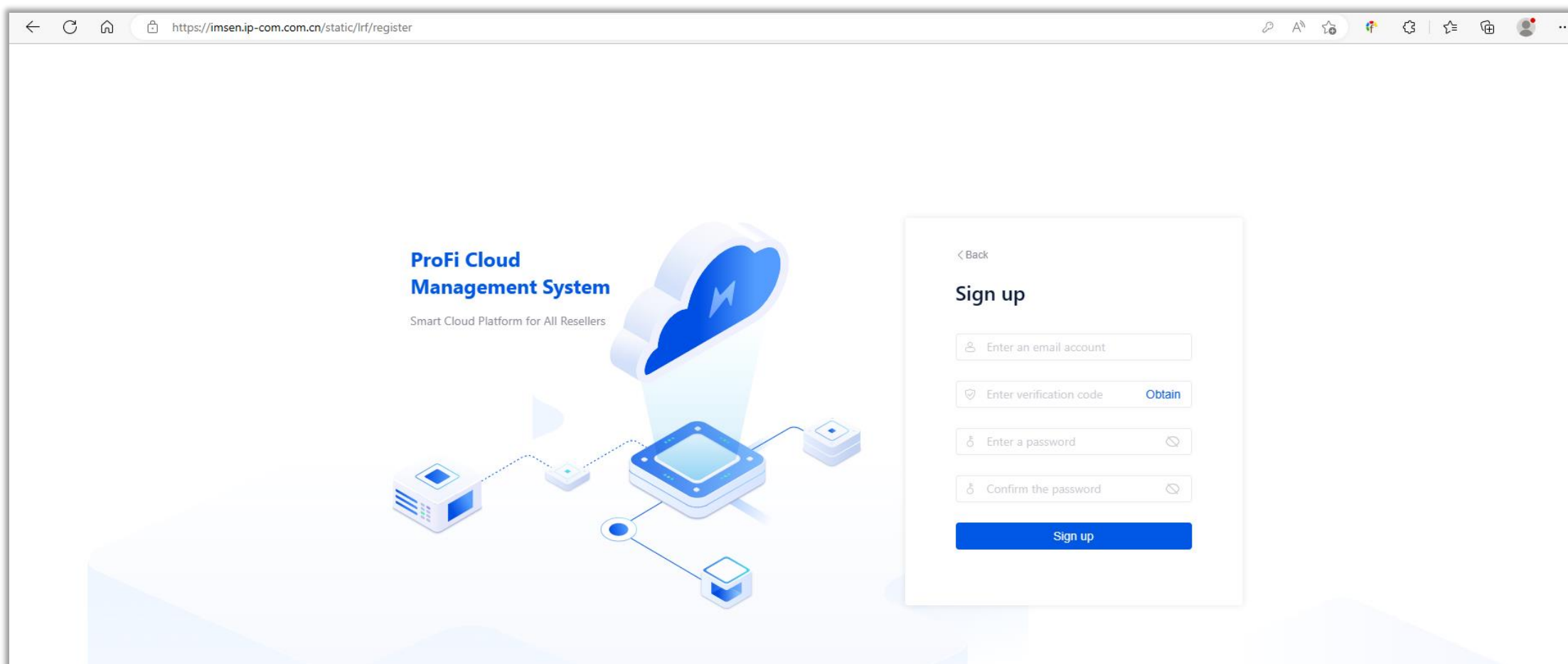

ProFi Cloud setup



- Accesso a **codice Cloud univoco**

IP-COM

 Start

 Andrea-Milanese



Overview



Project

Overview



Projects

2



Managed Devices

0

Add Project

Device-joining Alert

Unique Cloud Code

Demo Project

Online Devices

0



ProFi Cloud setup



- Impostazione del dispositivo per permettere la **gestione via Cloud**

The screenshot shows a web browser window with the IP-COM login page. The browser's address bar displays '192.168.0.252/login.asp'. The page header includes the IP-COM logo and the text 'Powered by Tenda World Wide Wireless'. The main content area features a network topology diagram with components labeled in Chinese and English: Gateway, Fat AP, In-Wall AP, Unified AC, and Switch. A login form is present with a red 'Login' button and a 'Forgot your password?' link. A text editor window is open over the login form, showing the text 'admin' and 'admin'.

ProFi Cloud setup



- Impostazione del dispositivo per permettere la **gestione via Cloud**

← ↻ ⚠ Not secure | 192.168.1.13/index.html#

IP-COM Logout

Status

Quick Setup

Internet Settings

Wireless

Advanced

Tools

Cloud Maintenance

Cloud Maintenance ☒

Management Mode Cloud Management

Unique Cloud Code 26988d865f5dcbc0e8e4a6

Unique Cloud Code is used to associate the device to your IP-COM cloud platform account. To get the code, you can either log in to the Web UI (<https://imsen.ip-com.com.cn>) or the IP-COM IMS App, and go to the Account Center to find it.

Report ☒ Enable

If disabled, the device cannot be managed and maintained over the cloud server.

Save Cancel

ProFi Cloud setup



- Creazione **Progetto**

IP-COM

+ Start

Andrea-Milanese



Overview



Project

Overview



Projects

1



Managed Devices

2



Online Devices

0



Traditional WLAN Projects

1



Cable-free WLAN Projects

0



Online Clients

0

Add Project

Device-joining Alert

Unique Cloud Code

Demo Project

See Fullscreen Data



No unread alarms within a week

ProFi Cloud setup



- Creazione **Progetto**

The screenshot shows the IP-COM ProFi Cloud setup interface. A modal window titled "Add Project" is open, displaying a form with the following fields: "Project Name" (text input), "Project Scenario" (dropdown menu), "Project Location" (dropdown menu), "Time Zone" (dropdown menu), and "Project Type" (dropdown menu). Below the form, there is a section titled "Traditional WLAN" with a description: "For mainstream networking scenarios, used to manage gateways, switches and APs". The background shows the main dashboard with a sidebar containing "Overview" and "Project" (selected), and a main area with a "Project" table. The table has columns for "No.", "Status", and "Project Name". It lists two items, both with the status "No device added". The top navigation bar includes the IP-COM logo, a "Start" button, and a user profile for "Andrea-Milanese".

IP-COM

Overview

Project

All (2) Traditional WLAN (2)

No.	Status ↓	Project Name
1	No device added	te
2	No device added	Te

Total 2 items

Add Project

Project Name: Enter Project Name

Project Scenario: Select Project Scenario

Project Location: Select Project Location

Time Zone: (GMT+02:00) Harare, Pretoria

Project Type: Traditional WLAN

Traditional WLAN

For mainstream networking scenarios, used to manage gateways, switches and APs

Project Location: Search

Project Location	Online Devices
-Milano	-
-Monza e Brianza	-

ProFi Cloud setup



- Aggiunta **dispositivi** al progetto – **Cloud**

Device-joining Alert

Add Device to Project

<input type="checkbox"/>	Device Type	Model	MAC Address	Public IP Address	Request Time ↑
<input type="checkbox"/>	Gateway	M50v2_en	D8:38:0D:AE:1E:60	79.44.155.191	2023-04-24 10:15:35 (GMT)

Total 1 items < 1/1 > 10 items/page ▾

+ Start

Add Project

Device-joining Alert

Unique Cloud Code

Demo Project

ProFi Cloud setup



- Aggiunta **dispositivi** al progetto – **Mobile App**

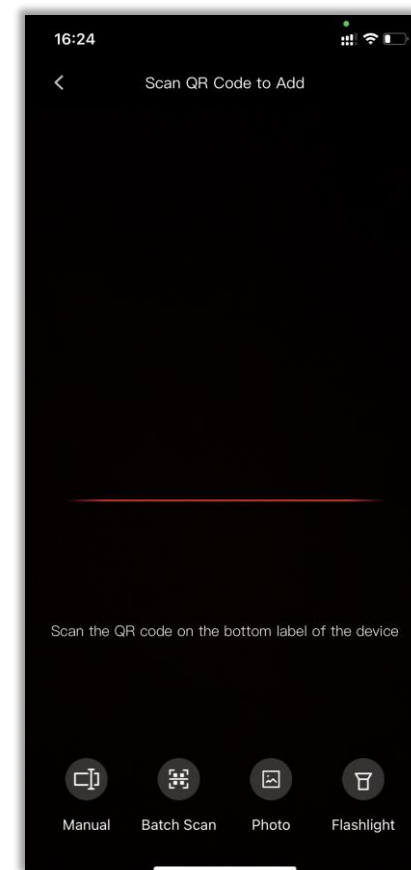
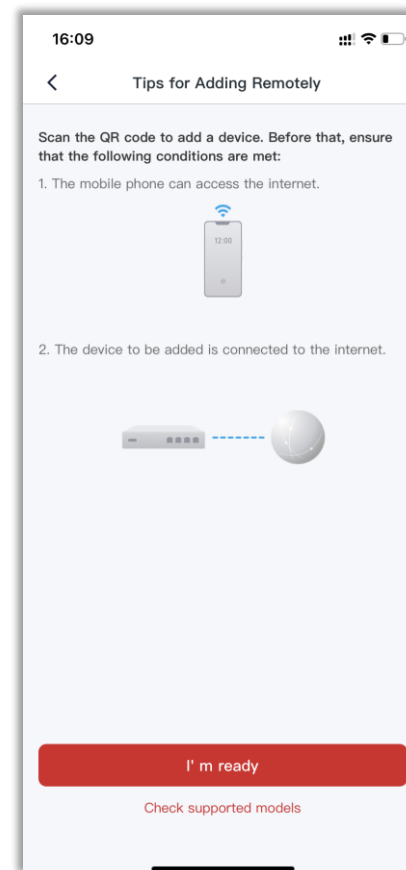
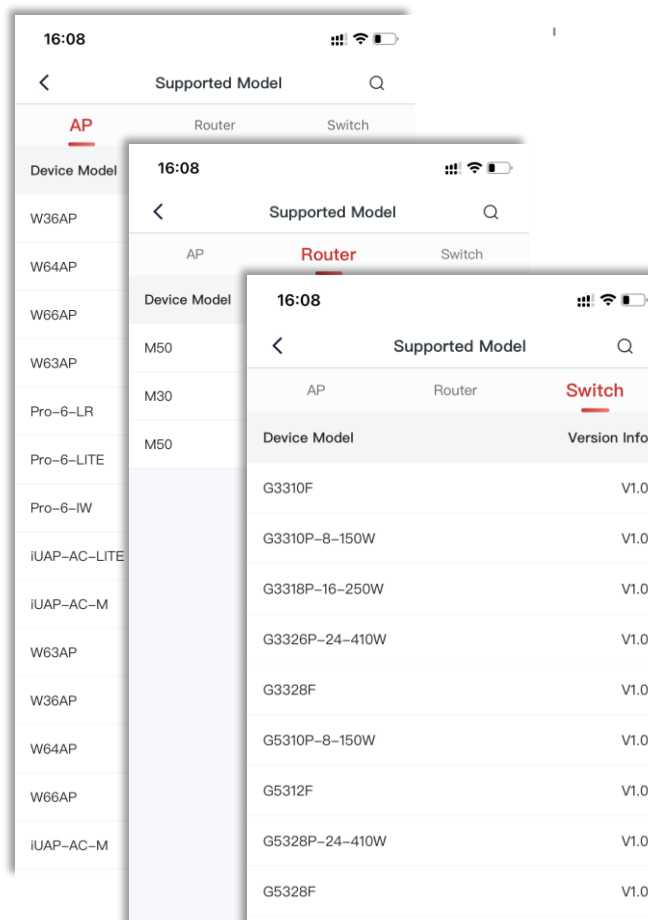
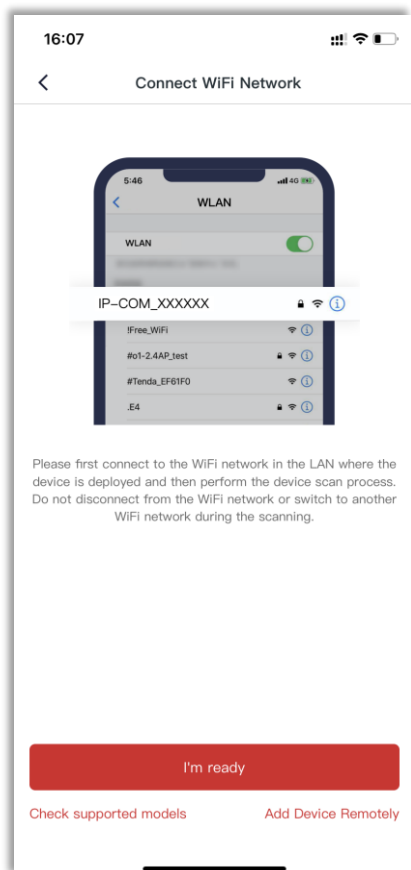
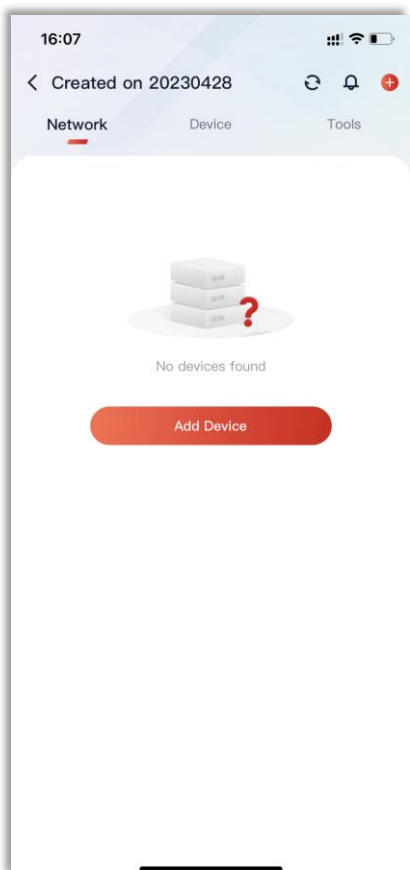

Overview

 See Fullscreen Data



Projects
2



Managed Devices
0



Online Devices
0



Traditional WLAN Projects
2



Cable-free WLAN Projects
0



Online Clients
0

Unread Alarm



No unread alarms within a week

Project Location

 Last 1 Month 



- Italy-Milano
- Italy-Monza e B...

Project Scenario

 Last 1 Month 



- Smart Home
- Hotel

Project

All (2)

Traditional WLAN (2)

Cable-free WLAN (0)

Add Project

Search

No.	Status ↓	Project Name	Project Property ⓘ	Project Type ⓘ	Project Scenario	Project Location	Online Devices	Offline Devices	Unread Alarms	Operation	
1	No device added	test	By Creation	Traditional WLAN	Hotel	Italy-Milano	-	-	-	Edit Delete Share	
2	No device added	Test M50	By Creation	Traditional WLAN	Smart Home	Italy-Monza e Brianza	-	-	-	Edit Delete Share	

Total 2 items

<

1

>

Go to

1

page

100 items/page

Status

Router



1

● Normal

Switch



3

● Normal

AP



6

● Normal

Cable-free



0

Online Client



100

Visualization



Network Topology

[Details >](#)

WAN Rate

(KB/s)

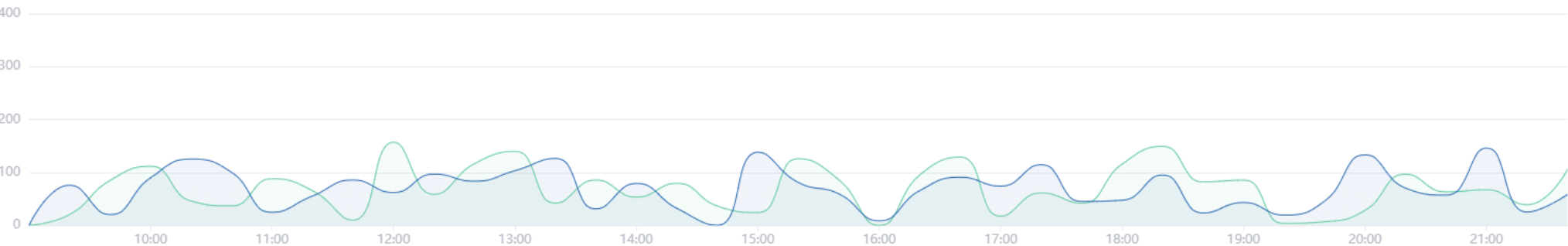

Online Clients

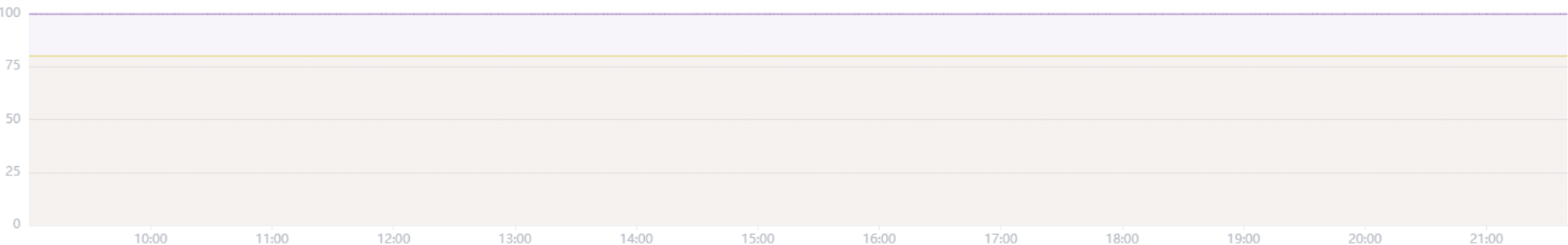

Network

Config

Data

Tool

Network

Status
Visualization **Beta**
| **Wi-Fi Map**
| Network Topology

Wi-Fi Map

Piano 1 Simulation: Phone Rx -74 dBm 2.4G Coverage

Add Floor Plan Edit Floor Plan

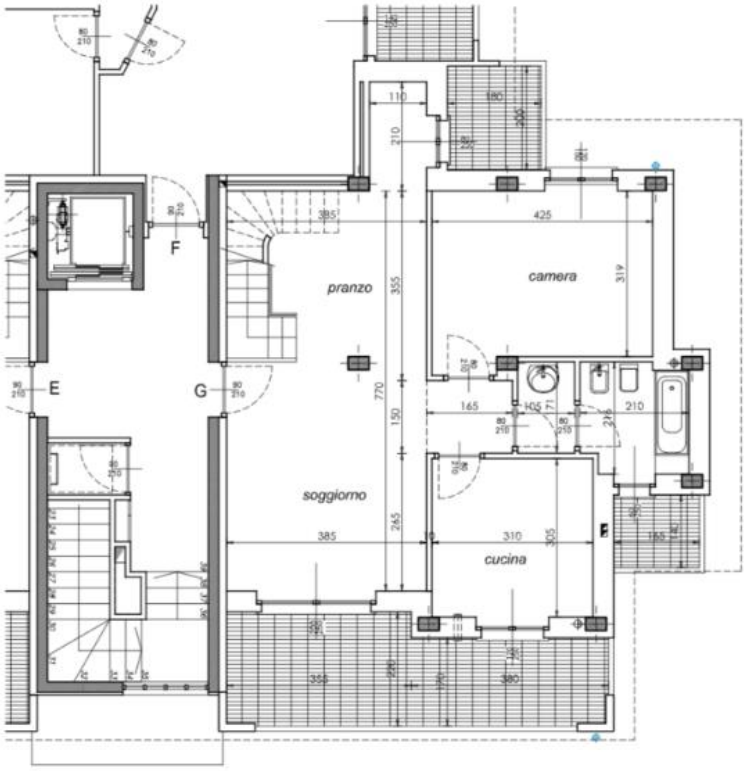

PIANO PRIMO

Screen Brightness 100 200 m

*The wireless thermodynamic simulation effect is obtained by the system based on the wireless signal technology theory and ProFi Cloud system algorithm. It may differ from the actual effect. Please use it properly with the actual scenarios.

Network

Config

Data

Tool

Network

Status
Visualization **Beta**
Wi-Fi Map
Network Topology

Wi-Fi Map

Piano 1 Simulation: Phone Rx -74 dBm 2.4G Coverage

Add Floor Plan Edit Floor Plan

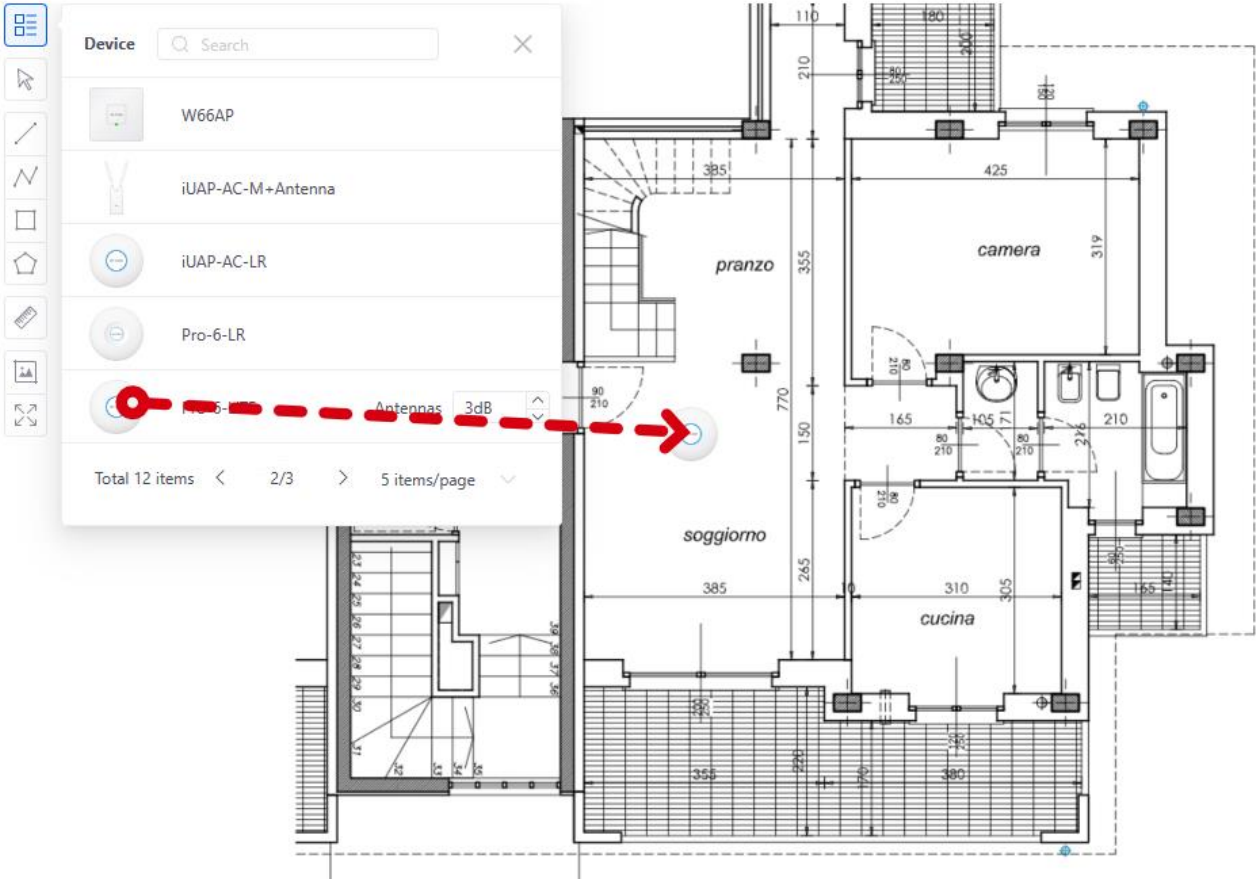

*The wireless thermodynamic simulation effect is obtained by the system based on the wireless signal technology theory and ProFi Cloud system algorithm. It may differ from the actual effect. Please use it properly with the actual scenarios.



Network

Status

Visualization **Beta**

Wi-Fi Map

Network Topology

Wi-Fi Map

Piano 1

Simulation: Phone Rx

-74

dBm

2.4G Coverage

Add Floor Plan

Edit Floor Plan



Select a wall type and start drawing. Press ESC to stop.

- Plasterboard (about 5 dB)
- ✓ Wooden wall (about 6.5 dB)
- Common glass (about 12 dB)
- Brick wall (about 20 dB)
- Colored/Coated glass (about 20 dB)
- Concrete wall (about 20 dB)
- Papered wall (about 23 dB)
- Bearing wall (about 28 dB)
- Customize Range: 1 - 99 dB

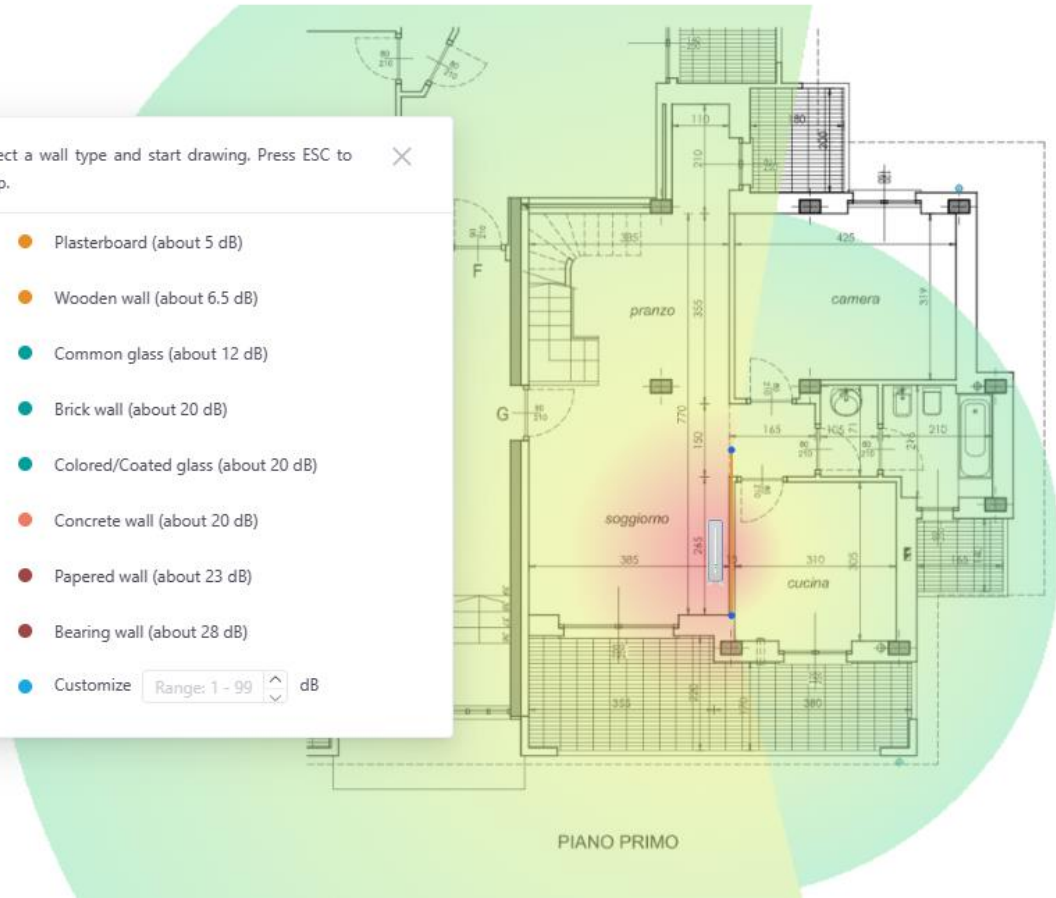

Screen Brightness 100 200 m

*The wireless thermodynamic simulation effect is obtained by the system based on the wireless signal technology theory and ProFi Cloud system algorithm. It may differ from the actual effect. Please use it properly with the actual scenarios.

Network

Network

Config

Data

Tool

Status
Visualization **Beta**
| **Wi-Fi Map**
| Network Topology

Wi-Fi Map

Piano 1 Simulation: Phone Rx -74 dBm 5G Coverage

Add Floor Plan Edit Floor Plan

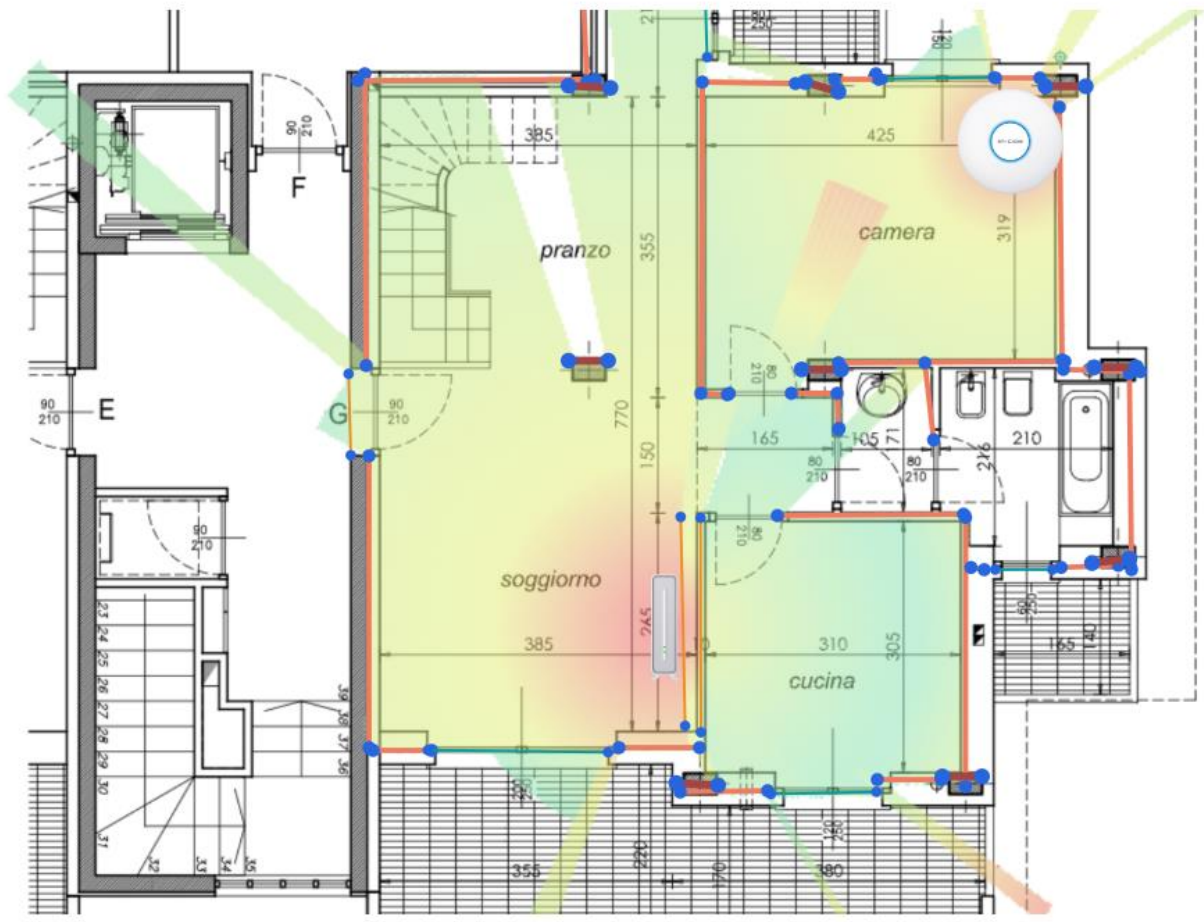

Screen Brightness 100 100 m

*The wireless thermodynamic simulation effect is obtained by the system based on the wireless signal technology theory and ProFi Cloud system algorithm. It may differ from the actual effect. Please use it properly with the actual scenarios.

Network

Config

Data

Tool

- Network
- Status
- Visualization Beta
- Wi-Fi Map
- Network Topology

Network Topology

Level Higher than AP Model Remarks IP Address MAC Address Port VLAN Topology

10 Gbps Wired 1 Gbps Wired 100 Mbps Wired Wireless Connection

Last Update: 2023.04.28 21:56 [Edit Topology](#)

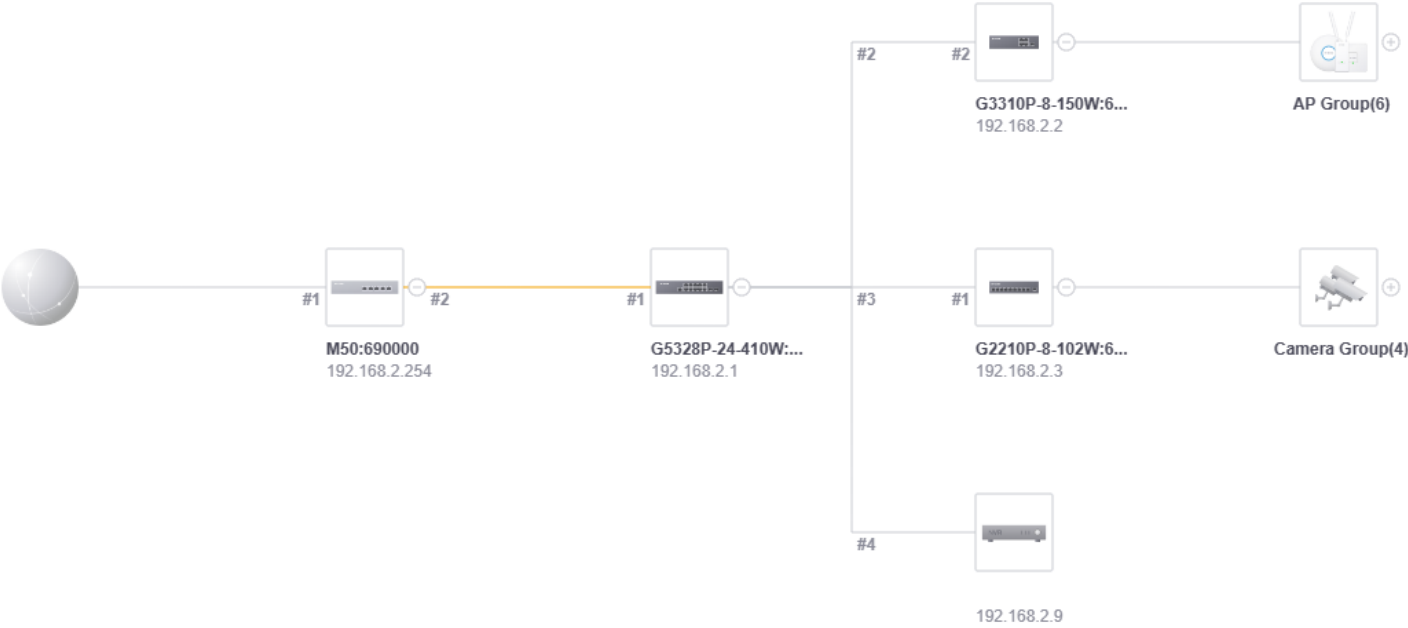

Network

Config

Data

Tool

Configuration

Network

Internet

VLAN

DHCP Policy

Static Route

Port Mapping

Wireless

RF Optimization

Device Maintenance

Internet

ⓘ Modifying network configuration on the WAN port may interrupt the internet connection. Operate with caution.

Port ↑	Physical Status	Network Status	Network Mode	Connection Duration	IP Address	Subnet Mask	Default Gateway	Operation	
WAN0	1000Mbps Full-duplex	Connected	Dynamic IP Address	14d 1h 1m 1s	192.168.2.50	255.255.255.0	192.168.2.11	Edit	
WAN1	1000Mbps Full-duplex	Connected	Static IP Address	14d 1h 1m 1s	192.168.2.51	255.255.255.0	192.168.2.11	Edit	

Total 2 items **1** Go to page

Network

Config

Data

Tool

Configuration

Network

Internet

VLAN

DHCP Policy

Static Route

Port Mapping

Wireless

RF Optimization

Device Maintenance

VLAN

The modification on VLAN takes effect only after you manually restart the device.

Add

Delete

<input type="checkbox"/>	No.	VLAN Name	Status	VLAN ID	IP Address	Subnet Mask	Port	Remarks	Operation
<input type="checkbox"/>	1	br0	Enable	1	192.168.0.12	255.255.255.0	LAN1	note	Edit Disable Delete

Total 1 items 1 Go to page

Network

Config

Data

Tool

Configuration

Network

Internet

VLAN

DHCP Policy

Static Route

Port Mapping

Wireless

RF Optimization

Device Maintenance

DHCP Policy

The modification on DHCP takes effect only after you manually restart the device.

Add

Delete

<input type="checkbox"/>	No.	Status	VLAN Name	VLAN ID	Port	Gateway Address	Subnet Mask	Start IP Address	End IP Address	Operation
<input type="checkbox"/>	1	Enable	br0	-	LAN1	192.168.0.1	255.255.255.0	192.168.0.2	192.168.0.254	Edit Disable Delete

Total 1 items

<

1

>

 Go to

1

 page

10 items/page

Edit DHCP Policy

VLAN Name

br0

VLAN ID

-

Port

LAN1

Gateway Address

192 · 168 · 0 · 1

Subnet Mask

255 · 255 · 255 · 0

DHCP Server

☒ Enable ☐ Disable

Start IP Address

192 · 168 · 0 · 2

End IP Address

192 · 168 · 0 · 254

Primary DNS

192 · 168 · 0 · 1

Secondary DNS

114 · 114 · 114 · 114 (Optional)

Lease Time

0 (min)

Cancel

Confirm



Network



Config



Data



Tool

Configuration

Network

Wireless

RF Optimization

Device Maintenance

Wireless

[Add](#) [Delete](#)

<input type="checkbox"/>	SSID	Security Mode	Wi-Fi Password	VLAN ID	Hide SSID	Max. Number of Clients
<input checked="" type="checkbox"/>	IP-COM-436E3B	WPA2-PSK	12345678	Disable	Disable	40
<input type="checkbox"/>	IP-COM-67B253	Not Encrypted	-	Disable	Disable	40

Total 2 items [<](#) **1** [>](#) Go to page

Deliver Wireless Policy

[Deliver](#) [Clear](#)

<input type="checkbox"/>	No.	Model	Status ↑	Remarks	Management Mode	IP Address	MAC Address	2.4G Policy
<input checked="" type="checkbox"/>	1	W63AP	Online	W63AP:690204	Cloud Management	192.168.2.4	95:88:84:69:02:04	IP-COM-67B253, IP-COM-436E3B
<input checked="" type="checkbox"/>	2	W63AP	Online	W63AP:690205	Cloud Management	192.168.2.5	95:88:84:69:02:05	IP-COM-67B253, IP-COM-436E3B
<input type="checkbox"/>	3	W63AP	Online	W63AP:690206	Cloud Management	192.168.2.6	95:88:84:69:02:06	IP-COM-67B253, IP-COM-436E3B
<input type="checkbox"/>	4	W63AP	Online	W63AP:690207	Cloud Management	192.168.2.7	95:88:84:69:02:07	IP-COM-67B253, IP-COM-436E3B
<input type="checkbox"/>	5	W36AP	Online	W36AP:690208	Cloud Management	192.168.2.8	95:88:84:69:02:08	IP-COM-67B253, IP-COM-436E3B
<input type="checkbox"/>	6	W36AP	Online	W36AP:690209	Cloud Management	192.168.2.9	95:88:84:69:02:09	IP-COM-67B253, IP-COM-436E3B

Total 6 items [<](#) **1** [>](#) Go to page

2 Batch Configuration (AP) [×](#)

Model	Remarks	Status ↑	Operatio
W63AP	W63AP:690204	Online	Remov
W63AP	W63AP:690205	Online	Remov

Total 2 items [<](#) 1/1 [>](#) 5 items/page [▼](#)

Auto Optimization Last Optimization: 2020-01-01 00:00:00

The system automatically collects and analyzes the usage of wireless resources to adjust configurations such as channel and power.

Optimize

Scheduled Optimization

Scheduled optimization is disabled.

Scheduled Optimization

Optimization Record

[Manual] RF optimized 1
[Manual] RF optimized 1

Details

Manual Optimization

	No.	Model	Status
<input checked="" type="checkbox"/>	1	W63AP	Online
<input checked="" type="checkbox"/>	2	W63AP	Online
<input type="checkbox"/>	3	W63AP	Online
<input type="checkbox"/>	4	W63AP	Online
<input type="checkbox"/>	5	W36AP	Online
<input type="checkbox"/>	6	W36AP	Online

Total 6 items 1 Go to 1 page 50

Scheduled Optimization

Scheduled Optimization

Start Time

00:00

Occurrence

Every Day

Monday

Tuesday

Wednesday

Thursday

Friday

☒ Saturday

Sunday

Cancel

Confirm

Batch Configuration (AP)

Model	Remarks	Status	Operation
W63AP	W63AP:690204	Online	Remove
W63AP	W63AP:690205	Online	Remove
Total 2 items 1/1 5 items/page			



Network



Config



Data



Tool

Configuration

- Network
- Wireless
- RF Optimization
- Device Maintenance

Device Maintenance

- All (10)
- Router (1)
- Switch (3)
- AP (6)
- Auto Maintenance
- Restart
- Reset
- Upgrade

No.	Model	Status	Remarks	Management Mode	IP Address	MAC Address	Software Version	Online Duration
1	M50	Online	M50:690000	Cloud Management	192.168.2.254	95:88:84:69:00:00	V16.01.0.5(2941)	14d 0h 0m 0s
2	G5328P-24-410W	Online	G5328P-24-410W:690101	Cloud Management	192.168.2.1	95:88:84:69:01:01	65.4.2.4	14d 0h 0m 0s
3	G3310P-8-150W	Online	G3310P-8-150W:690102	Cloud Management	192.168.2.2	95:88:84:69:01:02	65.4.2.4	14d 0h 0m 0s
4	G2210P-8-102W	Online	G2210P-8-102W:690103	Cloud Management	192.168.2.3	95:88:84:69:01:03	65.4.2.4	14d 0h 0m 0s
5	W63AP	Online	W63AP:690204	Cloud Management	192.168.2.4	95:88:84:69:02:04	V1.0.0.7(4511)	14d 0h 0m 0s
6	W63AP	Online	W63AP:690205	Cloud Management	192.168.2.5	95:88:84:69:02:05	V1.0.0.7(4511)	14d 0h 0m 0s
7	W63AP	Online	W63AP:690206	Cloud Management	192.168.2.6	95:88:84:69:02:06	V1.0.0.7(4511)	14d 0h 0m 0s
8	W63AP	Online	W63AP:690207	Cloud Management	192.168.2.7	95:88:84:69:02:07	V1.0.0.7(4511)	14d 0h 0m 0s
9	W36AP	Online	W36AP:690208	Cloud Management	192.168.2.8	95:88:84:69:02:08	V1.0.0.7(4511)	14d 0h 0m 0s
10	W36AP	Online	W36AP:690209	Cloud Management	192.168.2.9	95:88:84:69:02:09	V1.0.0.7(4511)	14d 0h 0m 0s

Total 10 items < **1** > Go to page

G5328P-24-410W:690101 Online

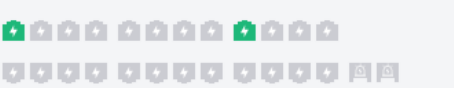

- 1G/10G 10M/100M Disconnect Disable
- SFP/SFP+ Uplink port PoE PoE disabled
- PoE Fault AP Camera Aggregate

Device Info

Model G5328P-24-410W
Software Version 65.4.2.4
IP Address 192.168.2.1
SN 000000000700001
MAC Address 95:88:84:69:01:01
Local Management Address -
Management Mode Cloud Management

Running Status

Network

Statistics

Config

Data

Tool

Device Data

Client Data

Client List

Device Data

Devices



5 APs with Most Users

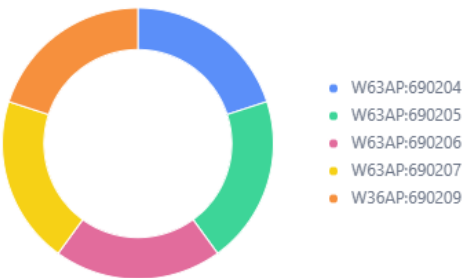

5 APs with Largest Throughput

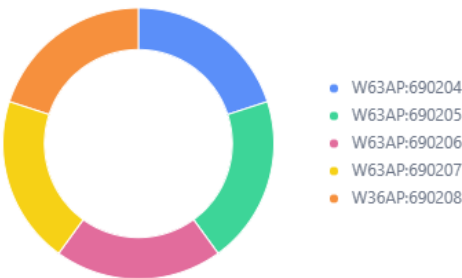

Client Data

Online Clients

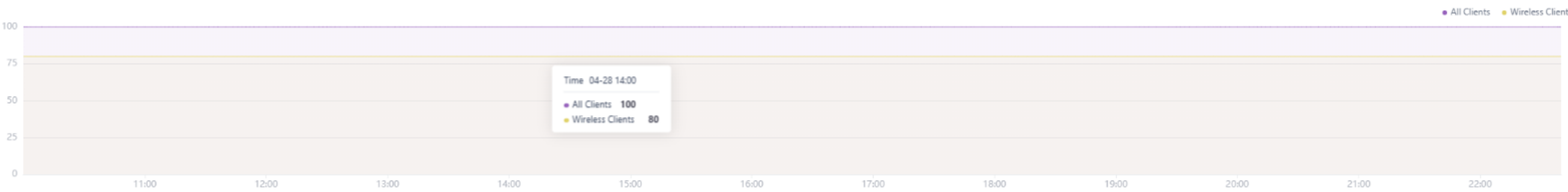

Wireless Network

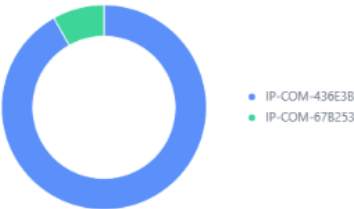

Client Traffic

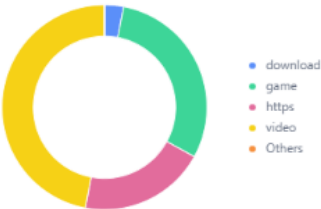

Wireless Client Manufacturer

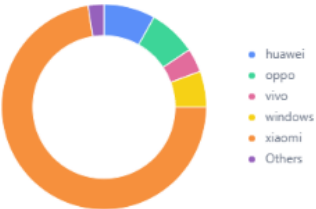

Wireless Client Signal Strength

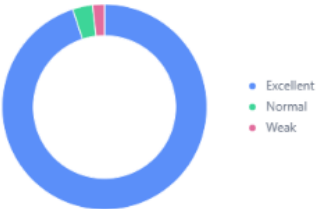



Network



Config



Data



Tool

Statistics

Device Data

Client Data

Client List

Client List

All (100) Wired (20) Wireless (80)

Force Offline

Search

<input type="checkbox"/>	No.	Client Name	IP Address	MAC Address	Client Type	Associated SSID	Associated Device	Signal Strength	Online Duration	Operation	
<input type="checkbox"/>	1	name21	192.168.2.72	75:29:93:63:76:97	Windows	IP-COM-436E3B	M50:690000	-54dBm	56d 10h 23m 37s	Force Offline	
<input type="checkbox"/>	2	name13	192.168.2.27	65:22:08:71:08:08	Unknown	IP-COM-436E3B	W63AP:690206	-62dBm	20h 59m 31s	Force Offline	
<input type="checkbox"/>	3	name7	192.168.2.68	43:56:84:57:42:77	Android	IP-COM-436E3B	M50:690000	-34dBm	18d 20h 36m 10s	Force Offline	
<input type="checkbox"/>	4	name62	192.168.2.25	93:30:59:22:26:93	Android	IP-COM-436E3B	W63AP:690206	-61dBm	50d 11h 48m 59s	Force Offline	
<input type="checkbox"/>	5	name26	192.168.2.31	58:02:01:05:15:31	Android	IP-COM-67B253	M50:690000	-48dBm	65d 17h 26m 40s	Force Offline	
<input type="checkbox"/>	6	name90	192.168.2.34	71:08:19:59:52:62	Windows	IP-COM-436E3B	M50:690000	-26dBm	67d 16h 57m 59s	Force Offline	
<input type="checkbox"/>	7	name39	192.168.2.29	77:88:68:44:57:55	Android	IP-COM-67B253	M50:690000	-4dBm	23d 7h 8m 43s	Force Offline	
<input type="checkbox"/>	8	name6	192.168.2.33	86:69:58:48:92:33	Mac OS	IP-COM-436E3B	W63AP:690206	-41dBm	46d 17h 43m 4s	Force Offline	
<input checked="" type="checkbox"/>	9	name97	192.168.2.85	70:34:60:74:19:09	Unknown	-	-	-	20d 22h 59m 7s	-	
<input type="checkbox"/>	10	name54	192.168.2.21	03:88:88:83:43:80	Android	IP-COM-436E3B	W63AP:690206	-32dBm	26d 13h 32m 47s	Force Offline	
<input type="checkbox"/>	11	name67	192.168.2.79	64:57:31:20:89:39	Android	IP-COM-436E3B	M50:690000	-77dBm	6d 20h 51m 9s	Force Offline	
<input type="checkbox"/>	12	name16	192.168.2.34	42:59:30:53:90:11	Unknown	IP-COM-436E3B	W63AP:690206	-42dBm	31d 12h 24m 23s	Force Offline	
<input type="checkbox"/>	13	name51	192.168.2.45	27:57:38:00:97:83	Mac OS	IP-COM-436E3B	M50:690000	-43dBm	41d 6h 54m 24s	Force Offline	
<input type="checkbox"/>	14	name6	192.168.2.80	71:05:22:68:94:49	Windows	IP-COM-436E3B	M50:690000	-67dBm	54d 17h 43m 16s	Force Offline	
<input checked="" type="checkbox"/>	15	name40	192.168.2.93	80:41:07:87:52:18	Mac OS	-	-	-	61d 21h 7m 36s	-	
<input type="checkbox"/>	16	name0	192.168.2.24	86:36:54:08:49:48	Unknown	IP-COM-436E3B	W63AP:690206	-42dBm	62d 13h 47m 10s	Force Offline	
<input type="checkbox"/>	17	name57	192.168.2.29	58:81:91:50:76:42	Unknown	IP-COM-436E3B	W63AP:690206	-9dBm	67d 4h 15m 59s	Force Offline	
<input type="checkbox"/>	18	name14	192.168.2.28	26:10:65:74:46:31	Windows	IP-COM-436E3B	W63AP:690206	-32dBm	10d 23h 30m 39s	Force Offline	
<input type="checkbox"/>	19	name75	192.168.2.32	29:05:85:86:41:87	Unknown	IP-COM-436E3B	W63AP:690206	-7dBm	52d 21h 11m 3s	Force Offline	
<input type="checkbox"/>	20	name40	192.168.2.59	85:61:83:75:56:11	Unknown	IP-COM-436E3B	M50:690000	-25dBm	11d 8h 15m 2s	Force Offline	

Total 100 items

1 2 3 ... 5

Go to 1 page

20 items/page

Permission

Permission Share

Search

Account	Role	Permission	Validity Period	Remarks	Operation
andrea-milanese@mail.com	Administrator	All Permissions	Permanent	-	<div>EditDelete</div>

Total 1 items

<

1

>

Go to

1

page

10 items/page

Tools

Permission

Log

Alarm

Backup

Log

Batch Delete

All7 daysSearch events

<input type="checkbox"/>	No.	Log Type	Event	Time ↓
<input type="checkbox"/>	1	System	Admin andrea-milanese@mail.com logged in from 93.56.216.156.	2023-04-28 14:40:39
<input type="checkbox"/>	2	System	Admin andrea-milanese@mail.com logged in from 93.56.216.156.	2023-04-28 12:48:50

Total 2 items1Go to1 page10 items/page

Network

Config

Data

Tool

Tools

Permission

Log

Alarm

Backup

Alarm

Alarm

Mark as Read

Batch Delete

7 days

Search events

<input type="checkbox"/>	No.	Status	Event	Time ↓
<input checked="" type="checkbox"/>	1	Unread	Wireless AP W63AP:690204 disconnected	2023-04-22 23:13:44
<input type="checkbox"/>	2	Unread	Wireless AP W63AP:690205 disconnected	2023-04-22 23:13:44
<input type="checkbox"/>	3	Unread	Wireless AP W63AP:690206 disconnected	2023-04-22 23:13:44

Total 3 items **1** Go to page

Network

Config

Data

Tool

Tools

Permission

Log

Alarm

Backup

Backup

Backup

Batch Delete

Search

<input type="checkbox"/>	No.	Associated Device	Configuration Remarks	Device IP	Device MAC	File Name	File Size	Backup Time ↓	Operation
No data									

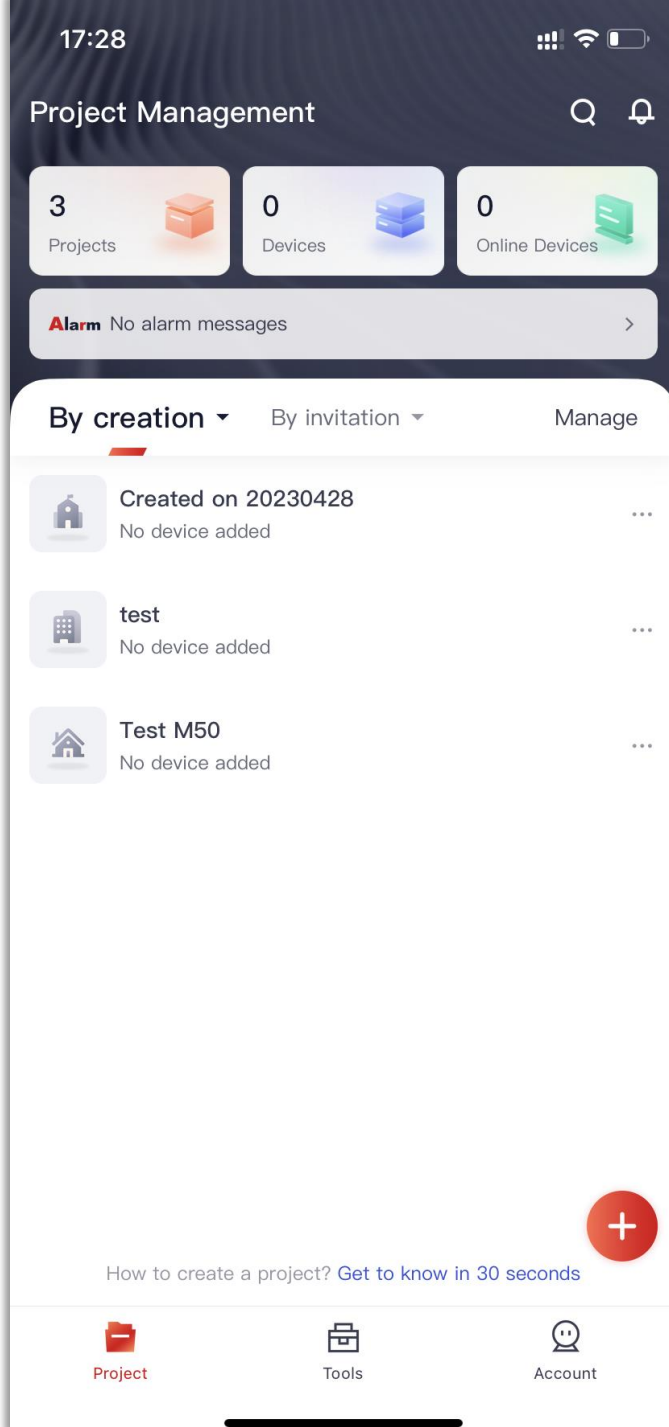

ProFi Mobile App

L'app è disponibile per tutti gli
smartphone con **iOS** e **Android**

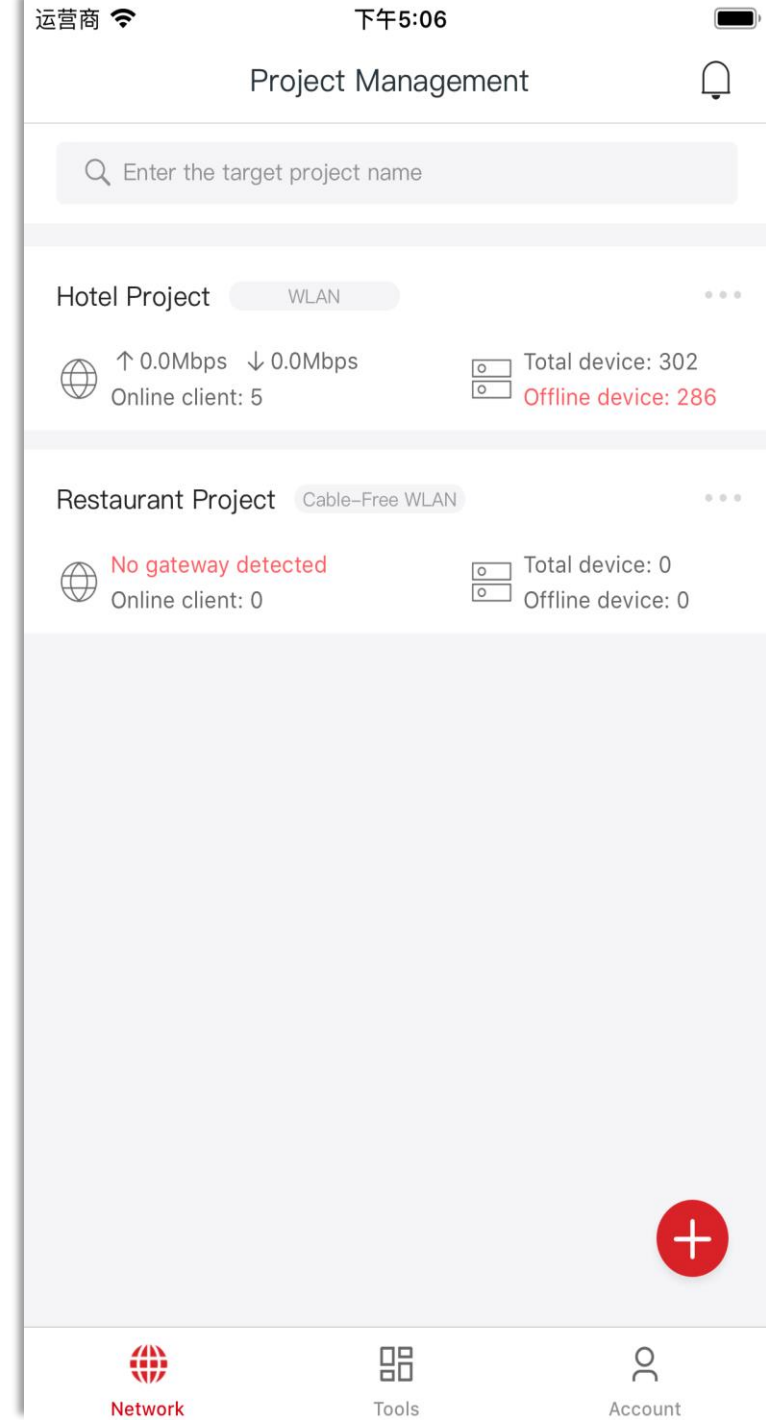

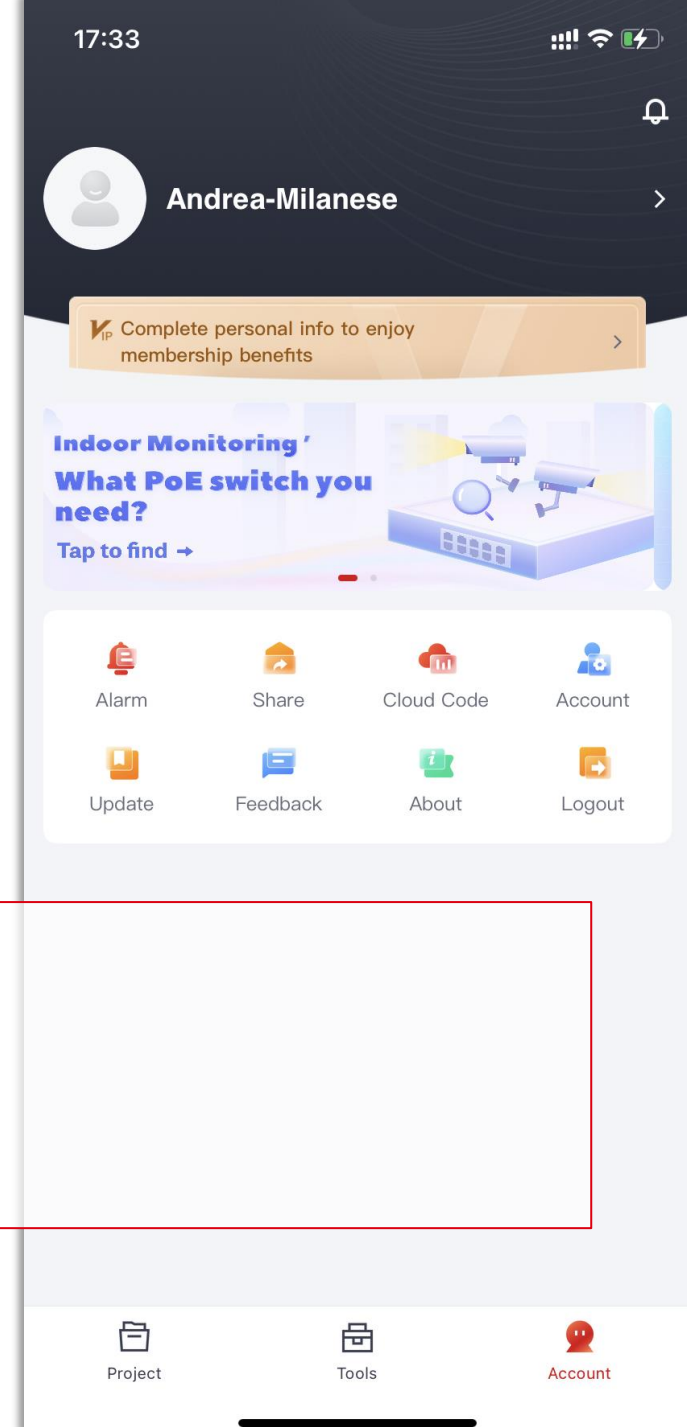
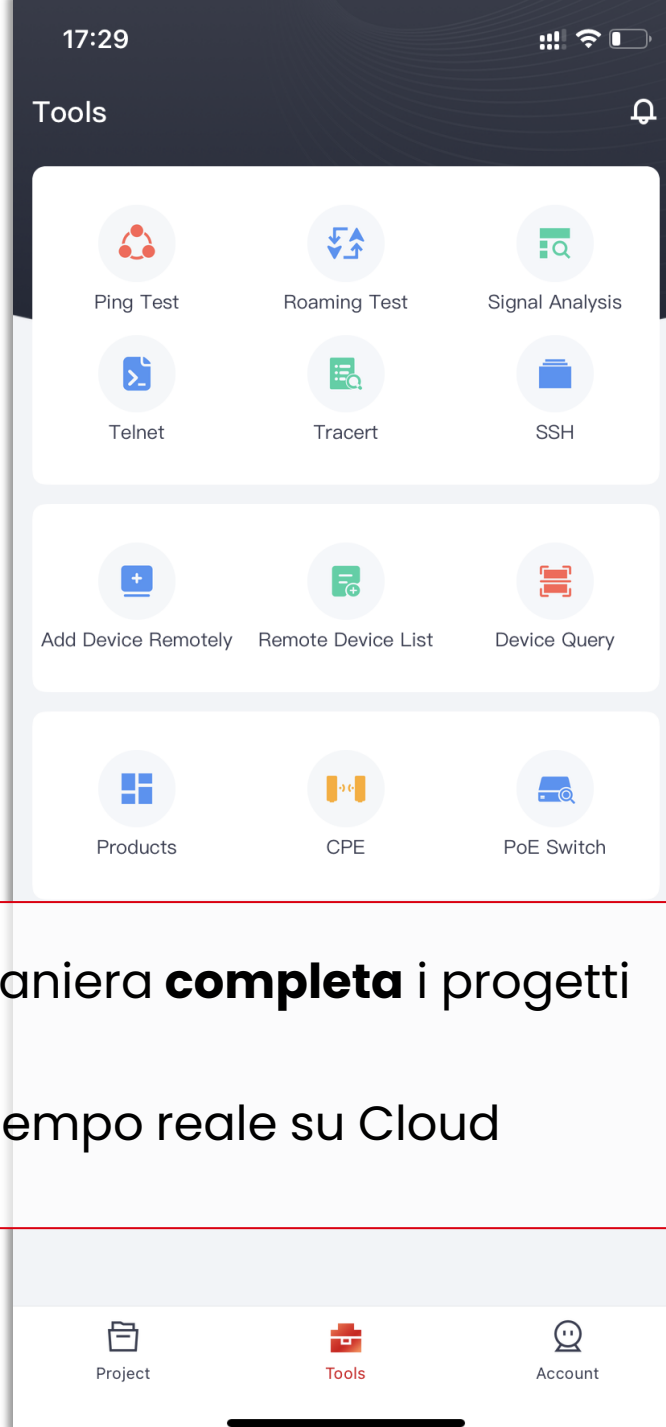
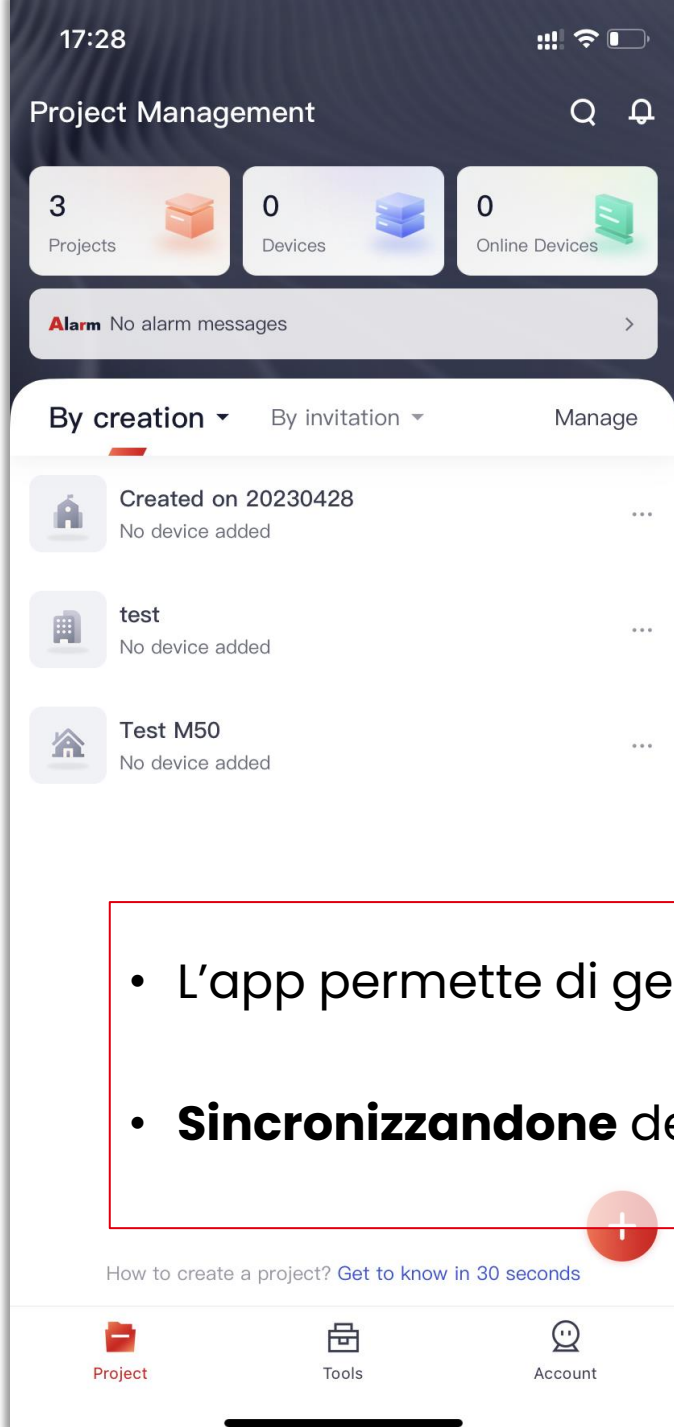

- L'app permette di gestire in maniera **completa** i progetti
- **Sincronizzandone** dei dati in tempo reale su Cloud

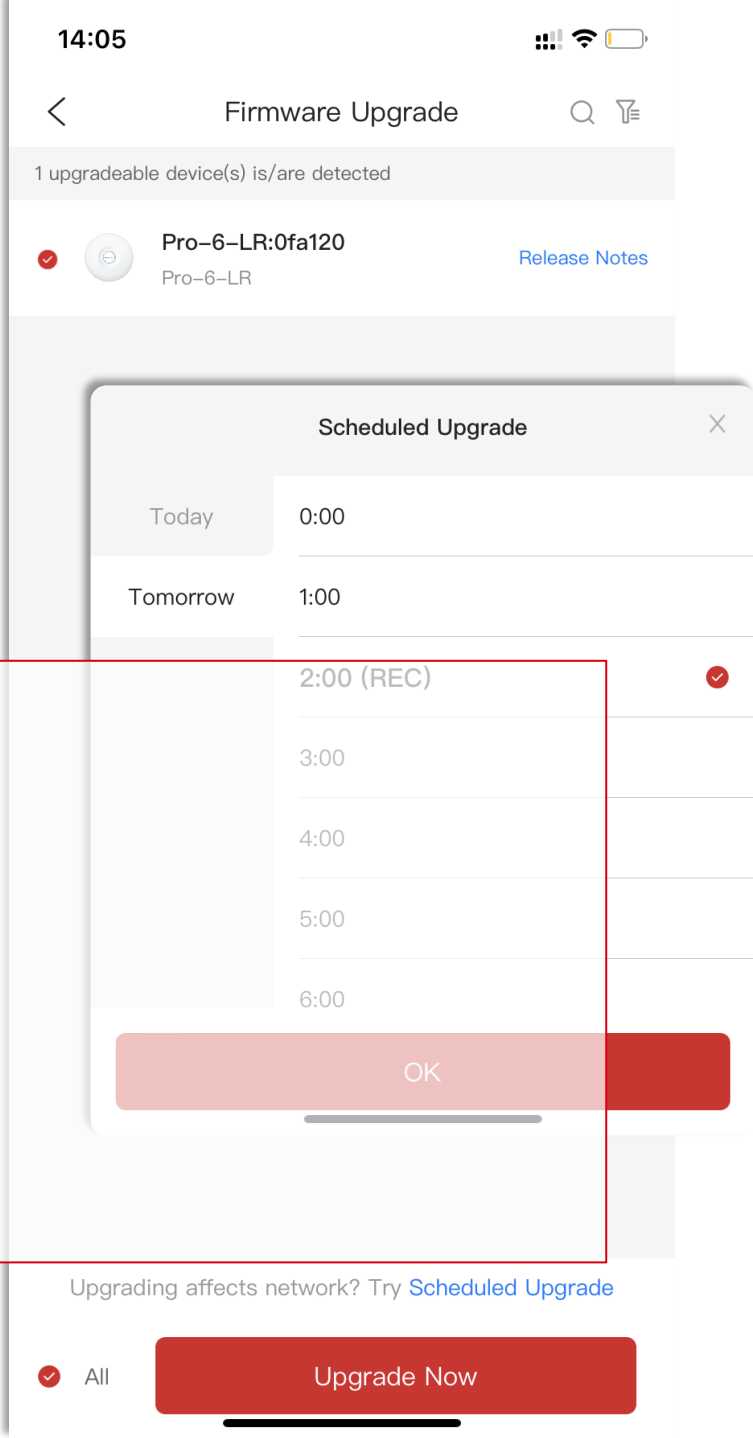
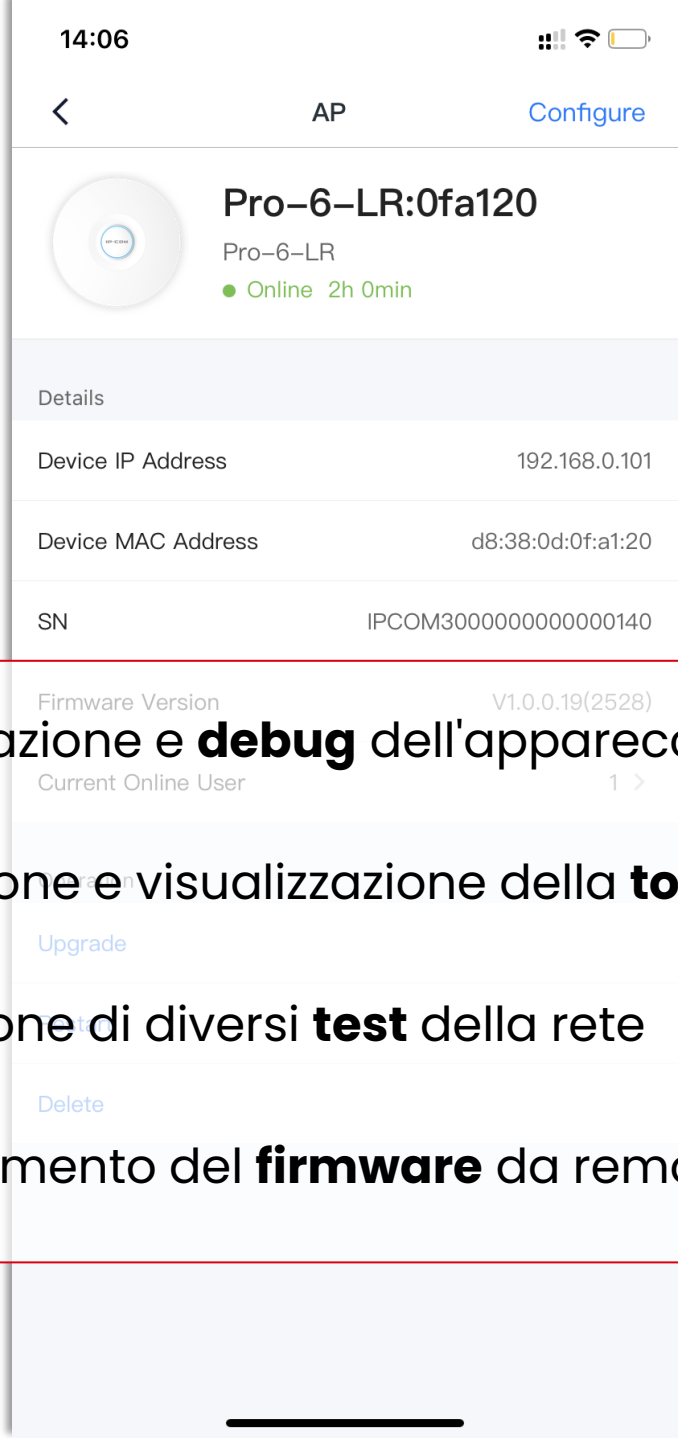
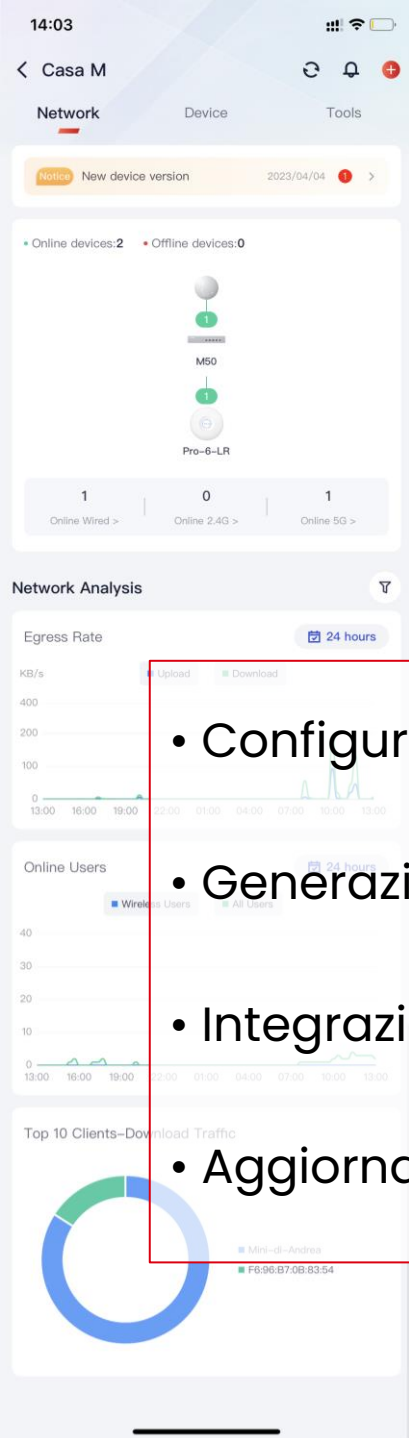

- Configurazione e **debug** dell'apparecchiatura
- Generazione e visualizzazione della **topologia** di rete
- Integrazione di diversi **test** della rete
- Aggiornamento del **firmware** da remoto

14:09



Connect WiFi Network



Please first connect to the WiFi network in the LAN where the device is deployed and then perform the device scan process. Do not disconnect from the WiFi network or switch to another WiFi network during the scanning.

[I'm ready](#)[Check supported models](#)[Add Device Remotely](#)

14:09

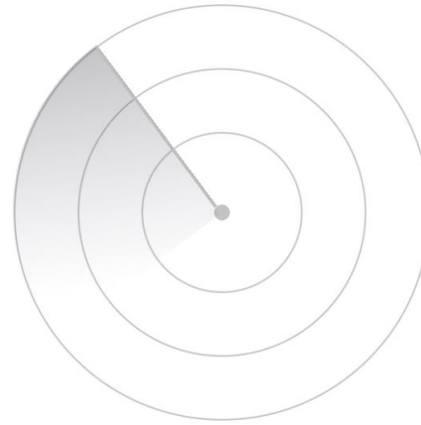

Automatic Scan

[Manual](#)

Scanning devices in the LAN...
Scanning takes some time... Please wait

14:14



Scan QR Code to Add



Scan the QR code on the bottom label of the device



Manual



Photo



Flashlight

- Connessione dei dispositivi al Cloud tramite una semplice scansione del **QR code**

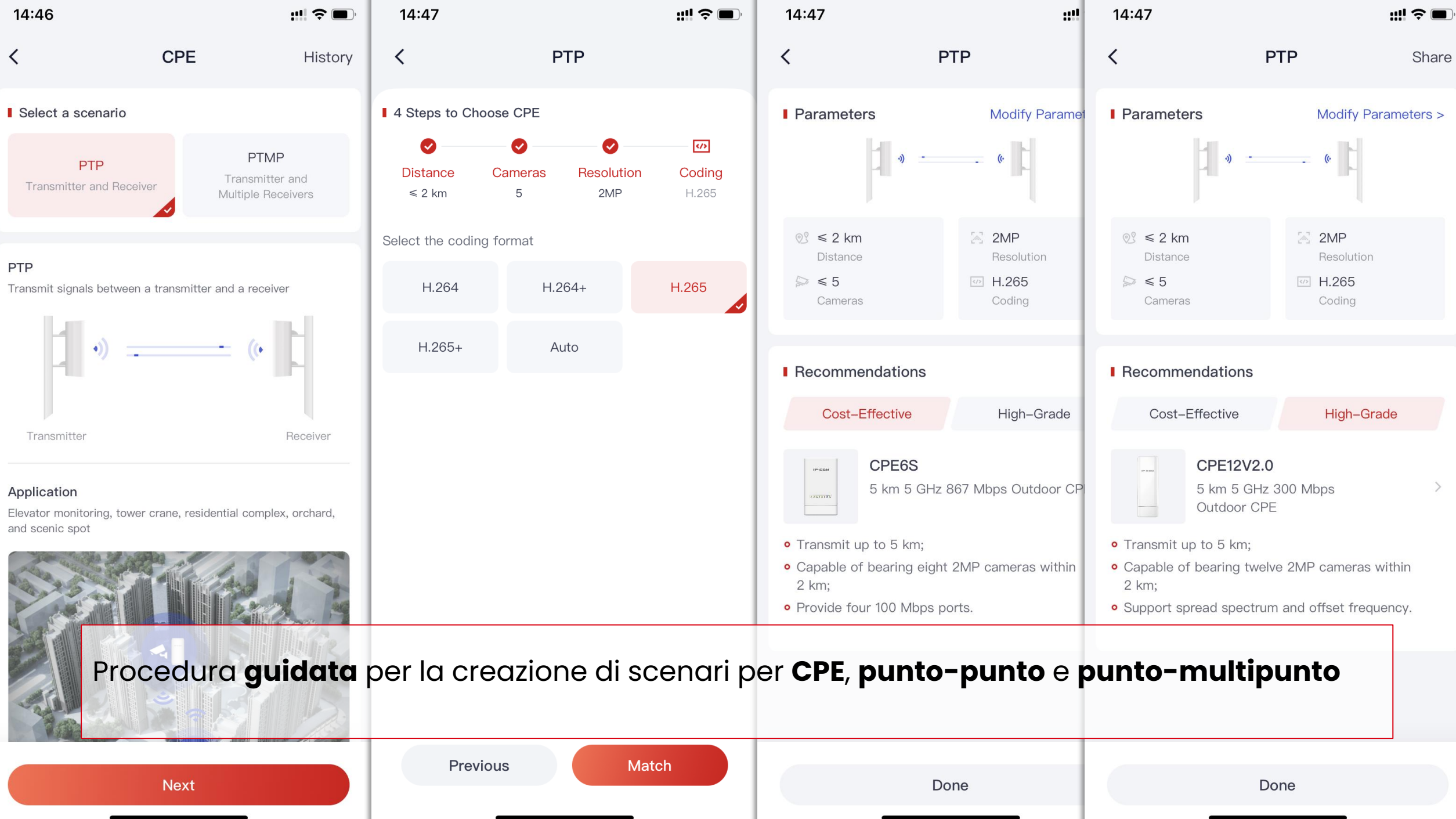

14:46

CPE

History

Select a scenario

PTP

Transmitter and Receiver

PTMP

Transmitter and Multiple Receivers

PTP

Transmit signals between a transmitter and a receiver

Transmitter

Receiver

Application

Elevator monitoring, tower crane, residential complex, orchard, and scenic spot

Procedura guidata per la creazione di scenari per CPE, punto-punto e punto-multipunto

Next

14:47

PTP

4 Steps to Choose CPE

Distance

≤ 2 km

Cameras

5

Resolution

2MP

Coding

H.265

Select the coding format

H.264

H.264+

H.265

H.265+

Auto

Previous

Match

14:47

PTP

Parameters

Modify Parameters

≤ 2 km

Distance

≤ 5

Cameras

2MP

Resolution

H.265

Coding

Recommendations

Cost-Effective

High-Grade

CPE6S

5 km 5 GHz 867 Mbps Outdoor CP

Transmit up to 5 km;

Capable of bearing eight 2MP cameras within 2 km;

Provide four 100 Mbps ports.

Done

14:47

PTP

Share

Parameters

Modify Parameters >

≤ 2 km

Distance

≤ 5

Cameras

2MP

Resolution

H.265

Coding

Recommendations

Cost-Effective

High-Grade

CPE12V2.0

5 km 5 GHz 300 Mbps Outdoor CPE

Transmit up to 5 km;

Capable of bearing twelve 2MP cameras within 2 km;

Support spread spectrum and offset frequency.

Done

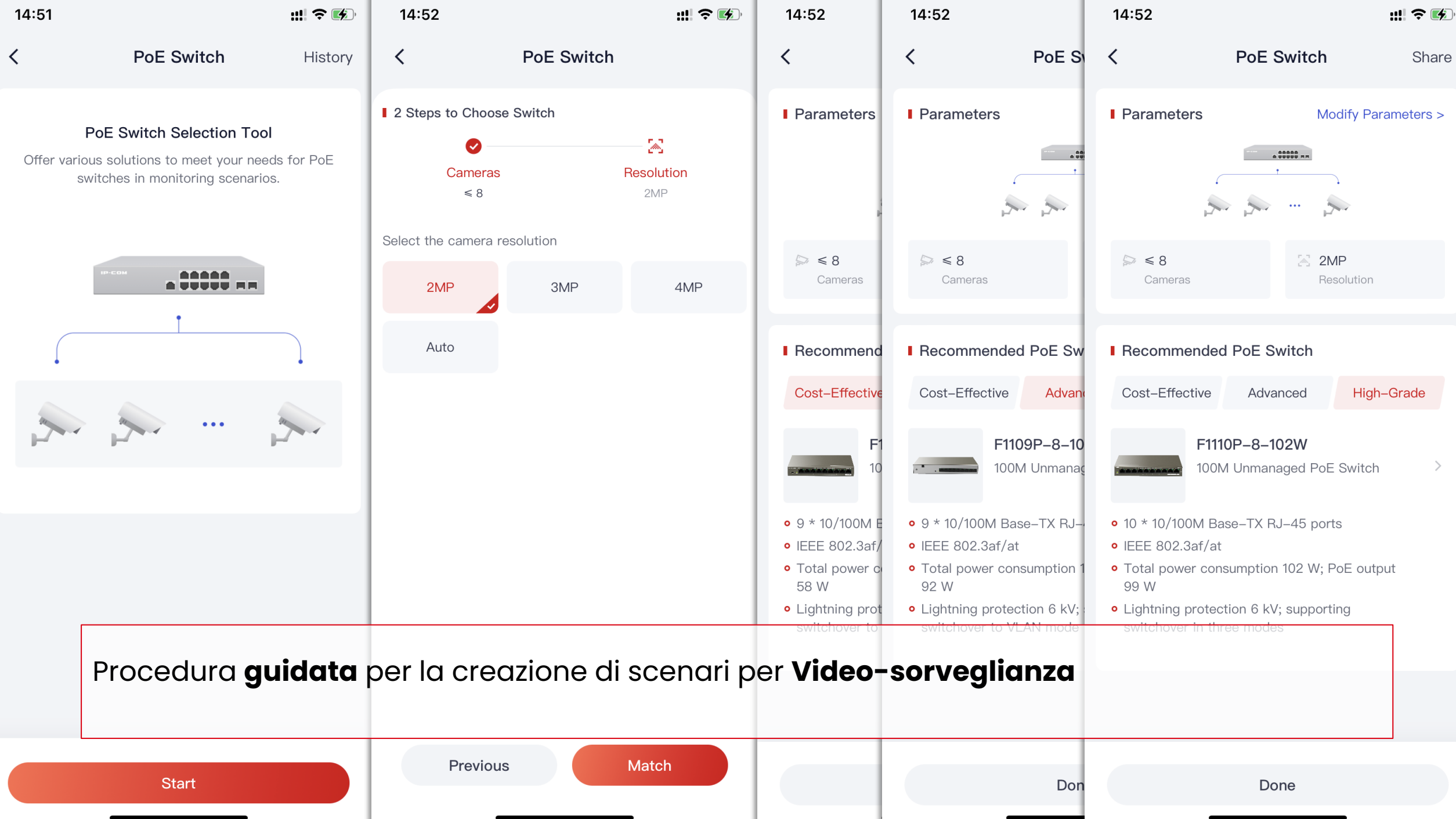

Procedura **guidata** per la creazione di scenari per **Video-sorveglianza**

FINE

Grazie per l'attenzione.

Massimo Decker

massimo.d@tenda.cn +39 380 76 66 370

Technical Sales Manager IP-COM & Tenda